



EAST AFRICAN STANDARD

Thermoplastics piping systems for non-pressure underground drainage and sewerage — Thermoplastics inspection chamber and manhole bases — Test methods for buckling resistance

EAST AFRICAN COMMUNITY

Foreword

Development of the East African Standards has been necessitated by the need for harmonizing requirements governing quality of products and services in East Africa. It is envisaged that through harmonized standardization, trade barriers which are encountered when goods and services are exchanged within the Community will be removed.

In order to meet the above objectives, the EAC Partner States have enacted an East African Standardization, Quality Assurance, Metrology and Test Act, 2006 (EAC SQMT Act, 2006) to make provisions for ensuring standardization, quality assurance, metrology and testing of products produced or originating in a third country and traded in the Community in order to facilitate industrial development and trade as well as helping to protect the health and safety of society and the environment in the Community.

East African Standards are formulated in accordance with the procedures established by the East African Standards Committee. The East African Standards Committee is established under the provisions of Article 4 of the EAC SQMT Act, 2006. The Committee is composed of representatives of the National Standards Bodies in Partner States, together with the representatives from the private sectors and consumer organizations. Draft East African Standards are circulated to stakeholders through the National Standards Bodies in the Partner States. The comments received are discussed and incorporated before finalization of standards, in accordance with the procedures of the Community.

Article 15(1) of the EAC SQMT Act, 2006 provides that "Within six months of the declaration of an East African Standard, the Partner States shall adopt, without deviation from the approved text of the standard, the East African Standard as a national standard and withdraw any existing national standard with similar scope and purpose".

East African Standards are subject to review, to keep pace with technological advances. Users of the East African Standards are therefore expected to ensure that they always have the latest versions of the standards they are implementing.

© East African Community 2010 — All rights reserved*

East African Community

P O Box 1096

Arusha

Tanzania

Tel: 255 27 2504253/8

Fax: 255-27-2504481/2504255

E-Mail: eac@eachq.org

Web: www.each.int

* © 2010 EAC — All rights of exploitation in any form and by any means reserved worldwide for EAC Partner States' NSBs.

Introduction

In the preparation of this East African Standard, the following source was consulted extensively:

ISO 13267:2010, *Thermoplastics piping systems for non-pressure underground drainage and sewerage — Thermoplastics inspection chamber and manhole bases — Test methods for buckling resistance*

Assistance derived from this source and others inadvertently not mentioned is hereby acknowledged.

Draft for comments only — Not to be cited as East African Standard

Thermoplastics piping systems for non-pressure underground drainage and sewerage — Thermoplastics inspection chamber and manhole bases — Test methods for buckling resistance

Systèmes de canalisations thermoplastiques pour branchements et collecteurs d'assainissement enterrés sans pression — Éléments de fond de boîtes d'inspection et de branchement et de regards thermoplastiques — Méthode d'essai de résistance au flambage



PDF disclaimer

This PDF file may contain embedded typefaces. In accordance with Adobe's licensing policy, this file may be printed or viewed but shall not be edited unless the typefaces which are embedded are licensed to and installed on the computer performing the editing. In downloading this file, parties accept therein the responsibility of not infringing Adobe's licensing policy. The ISO Central Secretariat accepts no liability in this area.

Adobe is a trademark of Adobe Systems Incorporated.

Details of the software products used to create this PDF file can be found in the General Info relative to the file; the PDF-creation parameters were optimized for printing. Every care has been taken to ensure that the file is suitable for use by ISO member bodies. In the unlikely event that a problem relating to it is found, please inform the Central Secretariat at the address given below.



COPYRIGHT PROTECTED DOCUMENT

© ISO 2010

All rights reserved. Unless otherwise specified, no part of this publication may be reproduced or utilized in any form or by any means, electronic or mechanical, including photocopying and microfilm, without permission in writing from either ISO at the address below or ISO's member body in the country of the requester.

ISO copyright office
Case postale 56 • CH-1211 Geneva 20
Tel. + 41 22 749 01 11
Fax + 41 22 749 09 47
E-mail copyright@iso.org
Web www.iso.org

Published in Switzerland

Contents

Page

Foreword	iv
1 Scope	1
2 Normative references	1
3 Terms and definitions	1
4 Principle.....	2
5 Apparatus	2
6 Conditioning	3
7 Test environment.....	3
8 Procedure	3
8.1 Internal negative pressure testing using a free standing test assembly	3
8.2 Internal negative pressure testing using a test box	5
8.3 External pressure testing with the assembly submerged in a water tank	6
8.4 Evaluation.....	7
9 Test report.....	8
Annex A (informative) Evaluation example	9

Draft for comments only — Not to be cited as East African Standard

Foreword

ISO (the International Organization for Standardization) is a worldwide federation of national standards bodies (ISO member bodies). The work of preparing International Standards is normally carried out through ISO technical committees. Each member body interested in a subject for which a technical committee has been established has the right to be represented on that committee. International organizations, governmental and non-governmental, in liaison with ISO, also take part in the work. ISO collaborates closely with the International Electrotechnical Commission (IEC) on all matters of electrotechnical standardization.

International Standards are drafted in accordance with the rules given in the ISO/IEC Directives, Part 2.

The main task of technical committees is to prepare International Standards. Draft International Standards adopted by the technical committees are circulated to the member bodies for voting. Publication as an International Standard requires approval by at least 75 % of the member bodies casting a vote.

Attention is drawn to the possibility that some of the elements of this document may be the subject of patent rights. ISO shall not be held responsible for identifying any or all such patent rights.

ISO 13267 was prepared by Technical Committee ISO/TC 138, *Plastics pipes, fittings and valves for the transport of fluids*, Subcommittee SC 1, *Plastics pipes and fittings for soil, waste and drainage (including land drainage)*.

Thermoplastics piping systems for non-pressure underground drainage and sewerage — Thermoplastics inspection chamber and manhole bases — Test methods for buckling resistance

1 Scope

This International Standard specifies methods of test for the resistance of the base of thermoplastics inspection chambers and manholes to external soil and ground-water pressure after installation.

2 Normative references

The following referenced documents are indispensable for the application of this document. For dated references, only the edition cited applies. For undated references, the latest edition of the referenced document (including any amendments) applies.

ISO 9967, *Thermoplastics pipes — Determination of creep ratio*

ENV 1046:2001, *Plastics piping and ducting systems — Systems outside building structures for the conveyance of water or sewage — Practices for installation above and below ground*

3 Terms and definitions

For the purposes of this document, the following terms and definitions apply.

3.1

inspection chamber

drainage or sewerage fitting used for the connection of drainage or sewerage installations and for changing the direction of drainage or sewerage runs

NOTE 1 An inspection chamber terminates at ground level, permitting the introduction of cleaning, inspection and test equipment and the removal of debris, but it does not provide access for personnel. The riser shaft connected to these fittings has a minimum outer diameter of 200 mm and a maximum inside diameter of less than 800 mm.

NOTE 2 The termination at ground level permits the introduction of cleaning, inspection and test equipment and the removal of debris but does not provide access for personnel.

3.2

manhole

drainage or sewerage fitting used for the connection of drainage or sewerage installations and for changing the direction of drainage or sewerage runs

NOTE 1 A manhole terminates at ground level, permitting the introduction of cleaning, inspection and test equipment and the removal of debris, and also providing access for personnel. The minimum inside diameter of a manhole riser shaft is 800 mm.

NOTE 2 The termination at ground level permits the introduction of cleaning, inspection and test equipment and the removal of debris and provides access for personnel.

4 Principle

A sealed test assembly, comprising an inspection chamber or manhole base with a minimum height of 300 mm above the top of the main channel, is placed free standing, or buried in a test box on a 100 mm sand or granular bed and covered with granular backfill to a level of minimum 300 mm above the top of the outlets and inlets of the main channel(s). In some cases, the first section of the riser may be required in order to achieve the minimum height of 300 mm.

The assembly is then subjected to a constant internal negative pressure, specified by the product or system standard, for a specified time at a temperature of between 15 °C and 25 °C or as otherwise specified in the product standard.

Alternatively, the pressure difference can be achieved by exposing the test assembly to a constant positive external hydrostatic pressure of the same numeric value as that specified by the product or system standard. The assembly is submerged under water in a closed tank for a specified time at a temperature of between 15 °C and 25 °C or as otherwise specified in the product standard.

During the test, the assembly may be monitored by measuring increasing deflections with time as defined in the product standard.

At the end of the test, the chamber base/manhole is visually checked for cracking or other defects likely to impair the performance of the inspection chamber or manhole.

5 Apparatus

5.1 Test box, large enough to accommodate the test assembly, including the first 300 mm of riser shaft above the top of the outlet and inlets of the main channel, such that at each side there is a free space of 300 mm minimum between the test assembly and the side/top of the test box.

5.2 Backfill material, to cover the test assembly in the box, conforming to ENV 1046:2001, Annex A. Backfill material shall be in accordance with the minimum specification of the manufacturer.

5.3 Sealable water tank or pressure vessel, with internal dimensions capable of accommodating the test assembly to ensure all-round clearance and a lockable lid allowing access to the open top of the inspection chamber or manhole. The water tank or pressure vessel shall be such that the test assembly is not able to gain support from the sides or base of the tank or vessel.

It is essential that the removable cover of the tank be designed in such a way that there is a watertight connection between the cover and the open top of the chamber/manhole shaft or base, and that there is an opening big enough for visual inspection inside the chamber or manhole.

The temperature of the water applied shall be (20 ± 2) °C or as otherwise specified in the product standard.

5.4 End closures, to seal any open pipe socket(s), spigot(s) and additionally, the riser shaft. When testing for structural integrity (20 °C), the end closures shall be created using standard pipes with end caps. If testing for durability at higher temperatures, plates welded to the end of the sockets or spigots may be used to seal the pipe connections.

5.5 Pressure or vacuum source, capable of applying and maintaining the test pressure specified in the product standard specification for the inspection chamber or manhole base as being the maximum pressure that the inspection chamber or manhole base shall be able to withstand (subject to a minimum of $-0,02$ MPa).

5.6 Pressure measuring devices, capable of measuring the internal negative or external water test pressure to within an accuracy of ± 2 %.

5.7 Thermometer, capable of measuring the temperature of the medium surrounding the test assembly to an accuracy of $\pm 0,5$ °C.

5.8 Deflection measuring equipment (optional), capable of measuring the deflection of the main channel to within an accuracy of $\pm 0,1$ mm. (If required by the product standard.)

5.9 Test assembly, comprising the base and a portion of the riser, if required, to ensure a height of at least 300 mm above the top of the main channel. Unless otherwise specified in the product standard, one test assembly shall be prepared for each test carried out.

NOTE The preferred configuration for testing the inspection chamber/manhole base is the straight through configuration without side entries.

6 Conditioning

Unless otherwise specified in the product standard, the test piece shall be tested no less than 21 days after manufacture and after conditioning in air for at least 6 h at a temperature of between 15 °C and 25 °C.

7 Test environment

Unless otherwise specified in the product standard, testing shall be carried out at a temperature of between 15 °C and 25 °C.

8 Procedure

8.1 Internal negative pressure testing using a free standing test assembly

8.1.1 Seal all inlets and outlets of the test assembly and the top of the riser shaft using the end closures.

NOTE 1 Internal or external tie bars can be used between the inlet and outlet closures to avoid the transmission of external end loading forces to the inspection chamber/manhole base via the end closures.

NOTE 2 The test assembly can be turned 180° upside down to simplify the test.

If the base is designed with a double wall, where the outer wall is designed to withstand upthrust, one or more 3 mm to 4 mm diameter holes shall be drilled through the inner wall to ensure that the internal negative pressure is loaded against the outside wall of the base assembly.

8.1.2 If the measurement of deflection is required by the product standard install the two devices for measuring deflection at points W and H , as shown in Figures 1 and 2.

In the case where bases are non-spherical, the relative vertical deformation of the base can be measured directly from a datum provided by a stiff beam connected at points H_L and H_R .

If a separate datum is used, the points H_L , H_R and H_M shall be measured from that datum during the test and the final deflection, expressed as Y_V , which is given by Equation (1):

$$Y_V = [(H_L + H_R)/2] - H_M \quad (1)$$

The change of the width of the main channel shall be expressed as Y_H , where this is the change to dimension W .

The sample shall be visibly inspected for evidence of cracks after completion of the test.

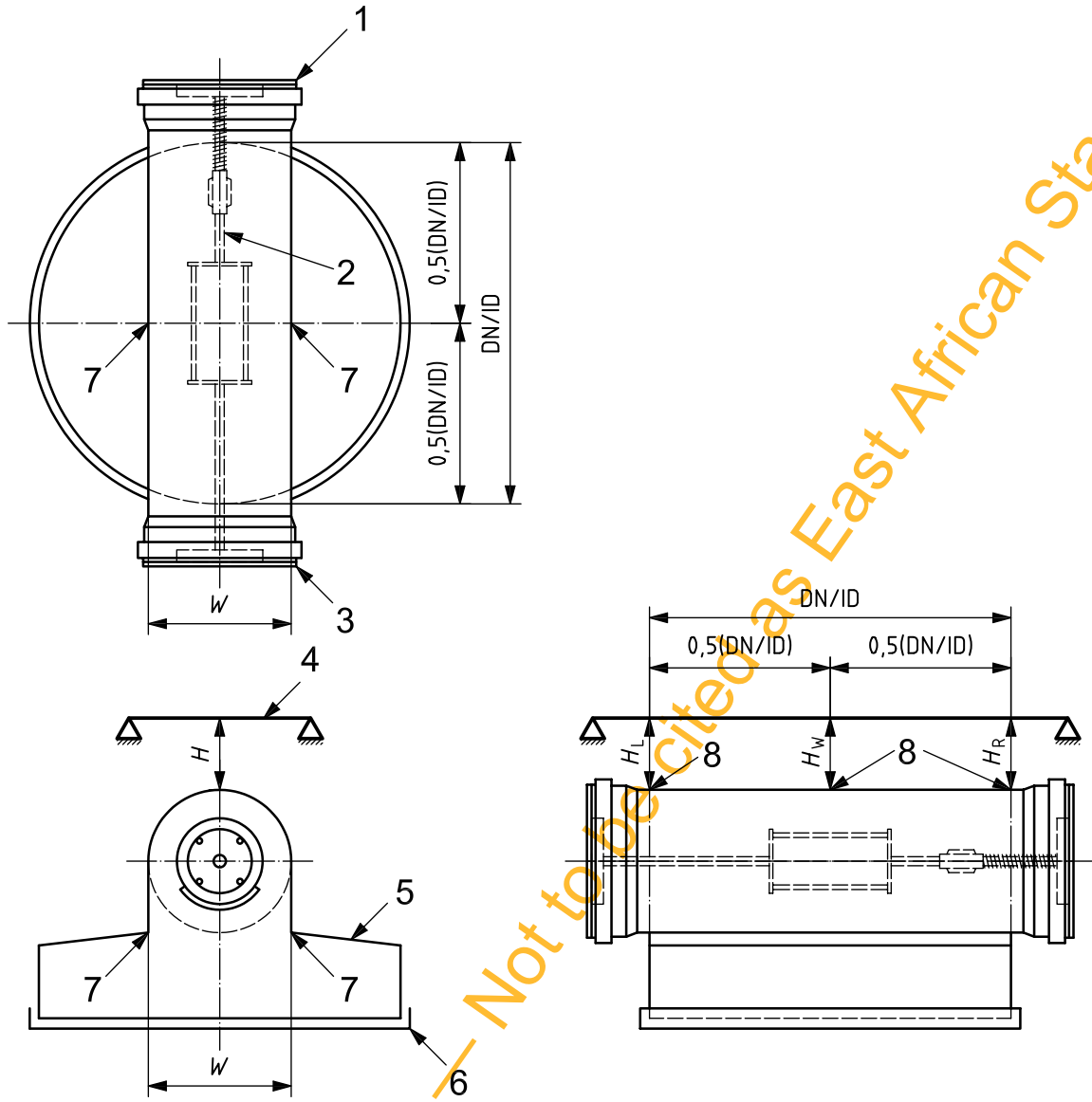

- Key**
- 1 plug-inlet
 - 2 plug support device
 - 3 plug-outlet
 - 4 reference
 - 5 base section
 - 6 removable cover
 - 7 measuring point for dimension W
 - 8 measuring point for dimension H

Figure 1 — Position of measuring devices in the main

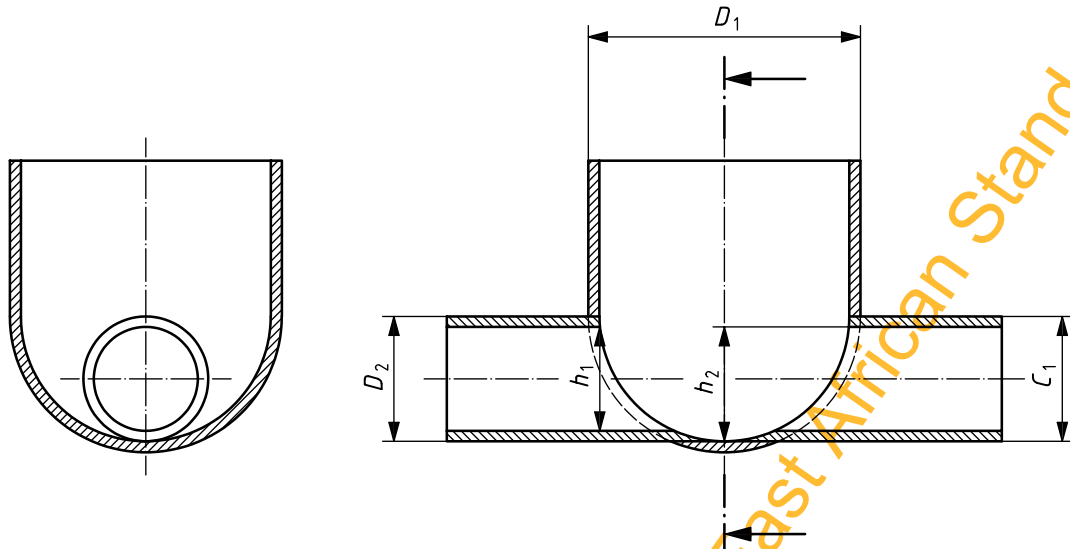
**Key**

C_1 diameter of connection 1

D_1 chamber diameter

D_2 outlet connection diameter

h_1 measure height at point 1, which points are located at inlet and outlet

h_2 measure height at point at the middle of the base

Figure 2 — Position of measuring devices for spherical bases

8.1.3 Connect the pressure source and pressure-measuring device to the test assembly and apply the internal negative pressure (see 5.5), maintaining it at between 15 °C to 25 °C or at the temperature specified in the product standard for a minimum of 1 000 h or for the time specified in the referring standard for the inspection chamber or manhole base within a tolerance of ± 2 %. If deflection measurements are required by the product standard, these shall be taken at the required defined intervals throughout the test.

8.2 Internal negative pressure testing using a test box

Prepare the test assembly as described in 8.1.1. Place the test assembly on a (100 ± 10) mm thick granular bed, in the position in which it would be installed, see Figure 3. Apply the backfill and compact to the minimum specified in the manufacturer's documentation (see 5.2). Connect and apply the test pressure as described in 8.1.3.

Dimensions in millimetres

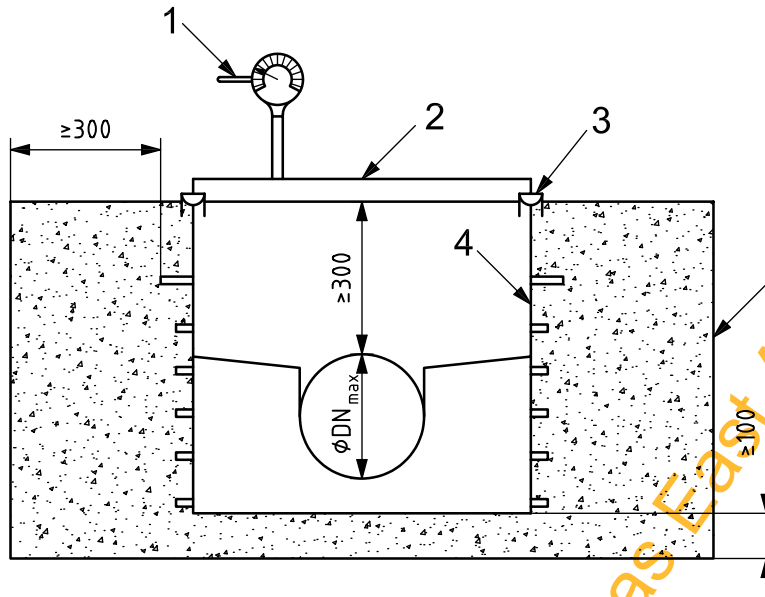

Key

- 1 vacuum source
- 2 cover
- 3 seal
- 4 base-component
- 5 tank/test box

Figure 3 — Test set-up when testing in a test box

8.3 External pressure testing with the assembly submerged in a water tank

Prepare the test assembly as described in 8.1.1.

It is permitted to cut back the riser shaft to a height of 300 mm above the top of the outlets and inlets of the main channel(s).

Place the assembly in the water tank and fill the annular space between tank and assembly with water. Lock the lid of the tank in position leaving access to the open top of the inspection chamber or manhole (see Figure 4).

Connect a pressure source and pressure-measuring device to the tank, apply the external test pressure (see 5.5) and maintain the pressure for the duration of the test, within a tolerance of $\pm 2\%$.

Dimensions in millimetres

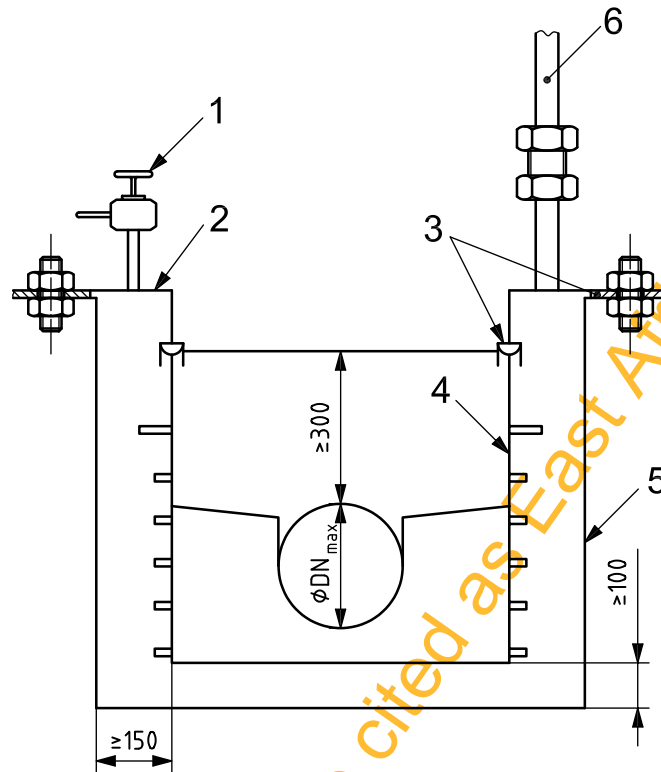
**Key**

- 1 vent valve
- 2 cover
- 3 seal
- 4 base-component
- 5 tank
- 6 water hose

Figure 4 — Test set-up of testing in a pressure vessel**8.4 Evaluation**

At the end of the test, observe the test assembly for any signs of cracking.

If extrapolation of the deflection data is required by the product standard, this shall be carried out by the method of least mean squares as generally described in ISO 9967 to 50 year time period as required, unless otherwise specified in the referring product standard.

NOTE Annex A shows an example of evaluation using the method of least mean squares.

9 Test report

The test report shall include the following information:

- a) reference to this International Standard, i.e. ISO 13267:2010, and the referring standard for the inspection chamber or manhole base;
- b) identification of the inspection chamber or manhole, including the nominal size(s) of the main channel(s);
- c) test procedure used and the soil type used, if testing with the test box;
- d) test pressure applied;
- e) test temperature;
- f) test duration time;
- g) if required by the referring standard, deflections generated at the end of the test or the predicted 50 year deflections as specified;
- h) visible crack(s);
- i) any factor noted during the test procedure that could have affected the test result, such as any incident or operating detail not covered in this International Standard;
- j) date of the test.

Draft for comments only — Not to be cited as East African Standard

Annex A (informative)

Evaluation example

Table A.1 — Evaluation example

Interval	Time h	$x = \lg t$	Deformation mm	Dataset	Trendline $y = ax + b$	R	1 000 h prediction mm
t_1	0,1	-1	0,83	t_1 to t_{11}	$y = 0,575\ 3x + 1,099\ 5$	0,967 4	2,83
t_2	1	0	1,08	t_2 to t_{11}	$y = 0,667\ 7x + 0,875$	0,974 7	2,88
t_3	4	0,602 1	1,27	t_3 to t_{11}	$y = 0,756\ 9x + 0,644\ 1$	0,976 4	2,92
t_4	24	1,380 2	1,58	t_4 to t_{11}	$y = 0,923\ 5x + 0,198\ 2$	0,981 9	2,97
t_5	168	2,225 3	2,09	t_5 to t_{11}	$y = 1,258\ 1x - 0,726\ 1$	0,998 4	3,05
t_6	336	2,526 3	2,45	t_6 to t_{11}	$y = 1,322\ 3x - 0,908\ 4$	0,997 7	3,06
t_7	504	2,702 4	2,65	t_7 to t_{11}	$y = 1,422\ 8x - 1,198\ 8$	0,999	3,07
t_8	600	2,778 2	2,75	—	—	—	—
t_9	696	2,842 6	2,84	—	—	—	—
t_{10}	864	2,936 5	2,99	—	—	—	—
t_{11}	1 008	3,003 5	3,07	—	—	—	—

The trendline ($y = 1,422\ 8x - 1,198\ 8$) shows the best prediction for the 1 000 h value and hence used for the prediction of the deformation after 50 years. If extended testing is required to generate an R correlation $> 0,9$, then the additional testing intervals beyond 1 000 h shall be as those specified in ISO 9967:2007, 8.3.

ICS 23.040.20; 23.040.45; 91.140.80; 93.030

Price based on 9 pages

Draft for comments only — Not to be cited as East African Standard